

MACALONEY'S CALEDONIAN DISTILLERY and TWA DOGS BREWERY

761 Enterprise Crescent
Saanich, BC

LOT 1, SECTION 8B, PLAN 33271
LEGAL LAND DISTRICT: LAKE

PID: 000-232-271

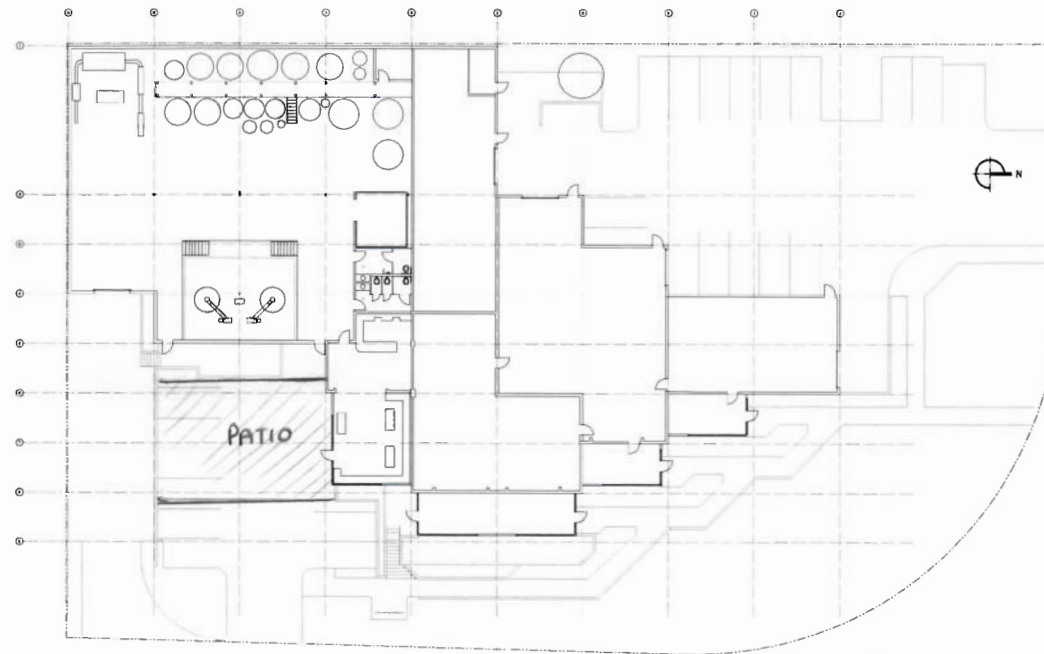

1 KEY PLAN
A0.0 1/8" = 1'-0"

DRAWING LIST

ARCHITECTURAL

- A0.0 COVER SHEET/ PROJECT INFORMATION
- A1.0 EXISTING FLOOR PLAN - LOWER LEVEL
- A1.1 EXISTING FLOOR PLAN - UPPER LEVEL
- A2.0 PROPOSED FLOOR PLAN - LOWER LEVEL
- A2.1 PROPOSED FLOOR PLAN - UPPER LEVEL
- A2.2 WASHROOM PLAN & ELEVATIONS

MECHANICAL

- M1 PLUMBING
- M2 HVAC & FIRE SUPPRESSION

ELECTRICAL

- E1.0 SITE PLAN, LEGEND, SCHEDULES AND DETAILS
- E2.0 EXISTING EVENT AREA LAYOUT
- E2.1 REVISED EVENT AREA LAYOUT

STRUCTURAL

- S1.1 GENERAL NOTES & TYPICAL DETAILS
- S2.1 PLANS AND DETAILS

building code review		British Columbia building code 2018 reference
municipal address	761 Enterprise Crescent Saanich, BC	
legal description	PID: 000-232-271	
project description	<input type="checkbox"/> change of use <input type="checkbox"/> new building <input type="checkbox"/> exterior alteration <input type="checkbox"/> addition <input type="checkbox"/> repair <input checked="" type="checkbox"/> change of use	
major occupancy(s)	Micro-Brewery, Micro-Distillery F2 Visitor's Centre: A2 Event Area: A2 Warehousing Areas: F2 Boiler Room: F2	3.1.2.1.
building area	1,621 m ² (17,448 sq ft)	3.2.2.5.
area of construction (m ²)	± 250 m ²	
number of storeys	above grade: 1 below grade: N/A	3.2.2.5.
number of levels	2	3.2.2.10.
building classification	3.2.2.23. Group A, Div. 2, Any Height, Any Area, Sprinklered 3.2.2.74. Group F, Div. 2, Any Height, Any Area, Sprinklered	3.2.2.20. to 3.2.2.90.
sprinklered throughout?	<input checked="" type="checkbox"/> yes <input type="checkbox"/> no	3.2.2.10.
standpipe required?	<input checked="" type="checkbox"/> yes <input type="checkbox"/> no	3.2.2.5.
fire alarm required?	<input checked="" type="checkbox"/> yes <input type="checkbox"/> no	3.2.4.1.
permitted construction	<input type="checkbox"/> combustible <input checked="" type="checkbox"/> non-combustible <input type="checkbox"/> both	3.2.2.20. to 3.2.2.90.
actual construction	<input type="checkbox"/> combustible <input checked="" type="checkbox"/> non-combustible <input type="checkbox"/> both	
occupant load	max: - building: 270	3.1.17.1.
occupant load based on...	<input checked="" type="checkbox"/> m ² / person <input type="checkbox"/> design of subbuilding	A2: 250 PERSONS (PUBLIC) F2: 20 STAFF
water closets required	male: 3 female: 5	3.7.2.2.
water closets provided	male: 4 female: 5	
travel distance	45 m	3.3.1.6., 3.4.2.5.
garage/room (min. required fire-resistance rating of fire separation)	<input type="checkbox"/> 1 h <input type="checkbox"/> 45 min <input checked="" type="checkbox"/> none	3.3.1.21.
minimum number of exits	every floor area intended for occupancy shall be served by at least 2 exits.	3.4.2.1.
accessible entrance(s) required?	<input checked="" type="checkbox"/> yes <input type="checkbox"/> no	3.8.2.2.
power door operator required at accessible entrance(s)?	<input checked="" type="checkbox"/> yes <input type="checkbox"/> no	3.8.2.7.
separation of major occupancies	minimum fire-resistance rating of fire separation (h) major occupancy: A-2 C D E F-1 F-2 F-3 adjacent major occupancy: A-2 C D E F-1 F-2 F-3	3.1.3.1.

KILO
ARCHITECTURE
Keith Alexander Telford, Architect - ABC, March, BC
1412 - 401 Street St. kel@kilowest.com 250-666-9870
Vancouver, BC V6V 1A4

THE CONTRACTOR SHALL VERIFY AND BE RESPONSIBLE FOR ALL
DIMENSIONS - TO NOT SCALE THE DRAWING.
ANY DISCREPANCY, OMISSION OR UNCLARIFIED SHALL BE
REPORTED TO KILLO ARCHITECTURE IMMEDIATELY.
CONSULTANTS



NOT TO SCALE

No. ISSUE YEAR MM-YY

REVISION

2. REVISED FOR PERMIT 2024-10-01

1. REVISED FOR COORDINATION 2024-09-11

No. ISSUE YEAR MM-YY

PROJECT NAME

Macaloney's
Caledonian Distillery
& Twa Dogs Brewery
761 Enterprise Crescent
Saanich, BC

LEGAL DESCRIPTION

DRAWN BY: KTD CHECKED BY: KAT DATE: SEPT 2023

ROLE: AS SHOWN PROJECT NO: 20-127

DRAWN NAME

COVER SHEET/
PROJECT INFORMATION

DRAWING NO.

A0.0

PERMIT NO.

REVISION